

- PROP. ALTERNATIVE ONSITE WASTEWATER TREATMENT SYS.:**
- 1- HYDRO-ACTION SET-N-GO AEROBIC ONSITE WASTEWATER TREATMENT PLANT
 - MODEL AN-500-C, GRAVITY FLOW SYSTEM INCLUDES:
 - PRE-TREATMENT (VOL. 54 GAL), AERATION CHAMBER (VOL. 990 GAL)
 - OPS (OP / CNTRL. CENTER) IN ALARM BEACON & AUDIBLE HORN ALARM
 - 2 - 8.5' x 4.75' x 2.5' EFF. DEPTH DISTRIBUTION LEACHING GALLEYS
 - 3 - 8.5' x 4.75' x 2.5' EFF. DEPTH LEACHING GALLEYS
 - 2 - 8.5' x 4.75' x 2.5' EFF. DEPTH EXPANSION LEACHING GALLEYS
 - SOB EXPANSION SKIRM TO BE INSTALLED UPON INITIAL INSTALLATION
 - MAINTAIN 5% GRADE OVER 20 LIN. FT. FROM SYSTEM
 - TOTAL SIDE WALL LEACHING AREA = 463.75 SQ.FT.

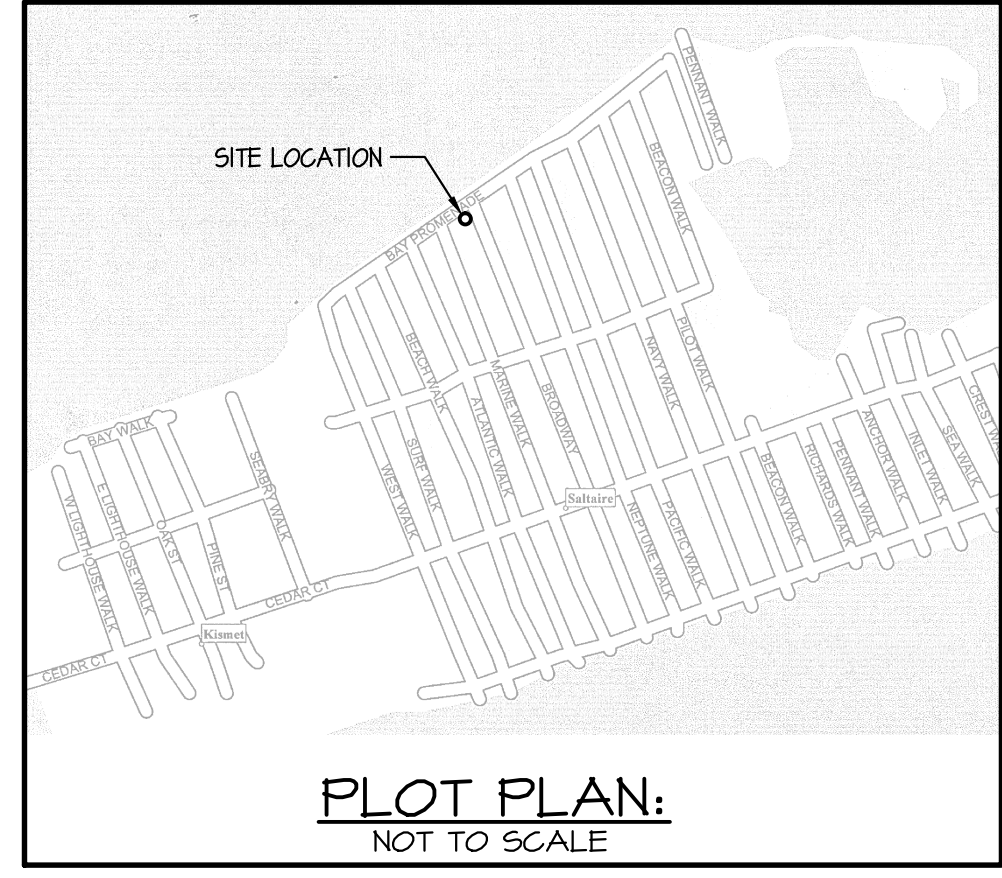
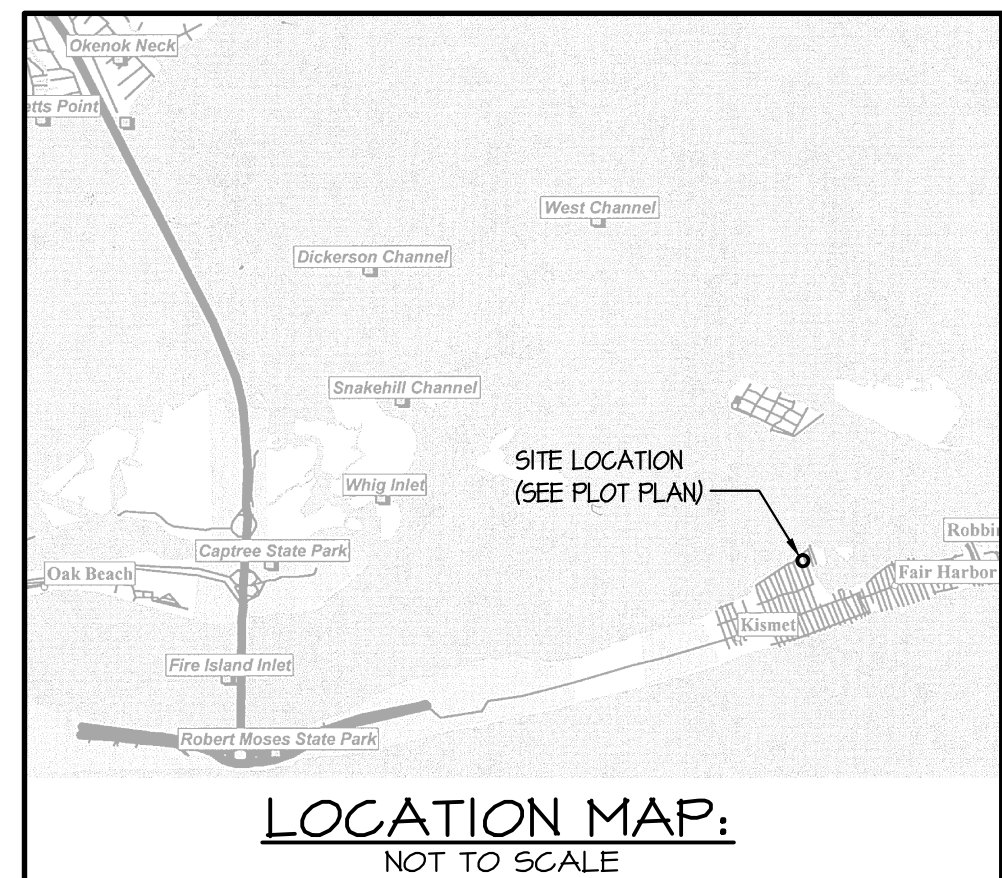
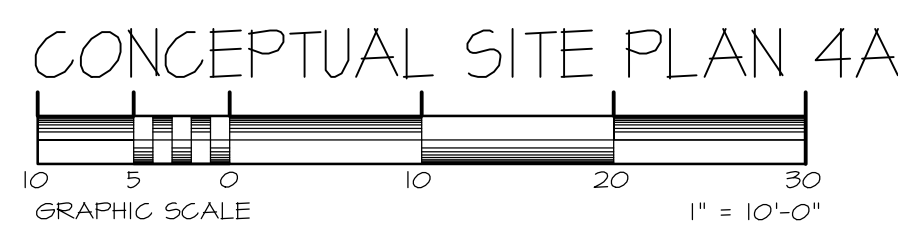
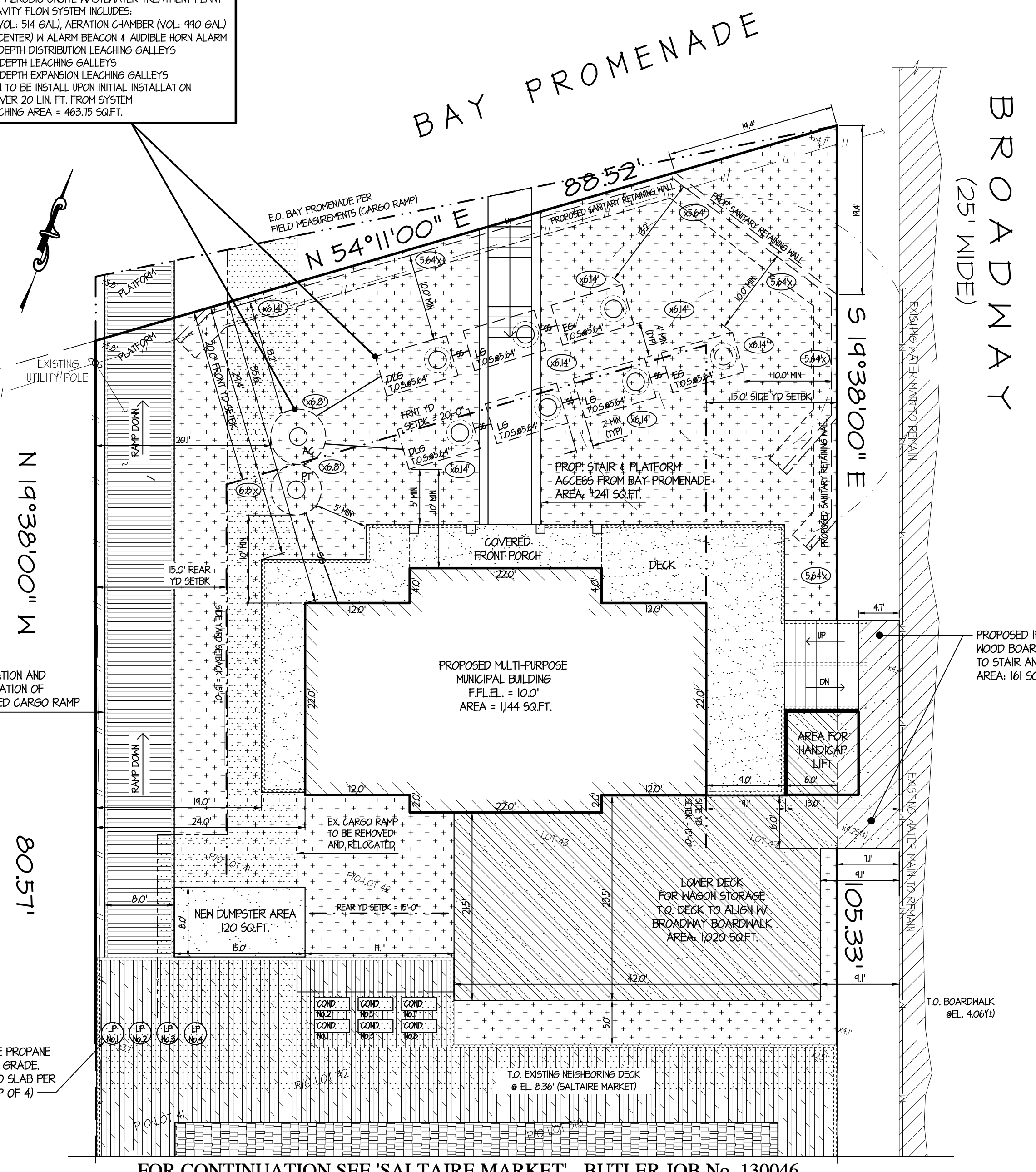
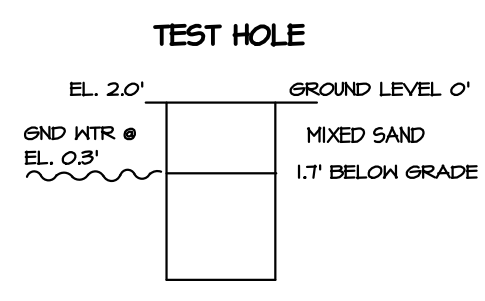

CONCEPTUAL SITE PLAN 4A:

SITUATE AT: BAY PROMENADE, SALTAIRE, NY
 APPLICANT / OWNER: VILLAGE OF SALTAIRE

TOWN OF ISLIP, SUFFOLK COUNTY, NEW YORK

REVISIONS

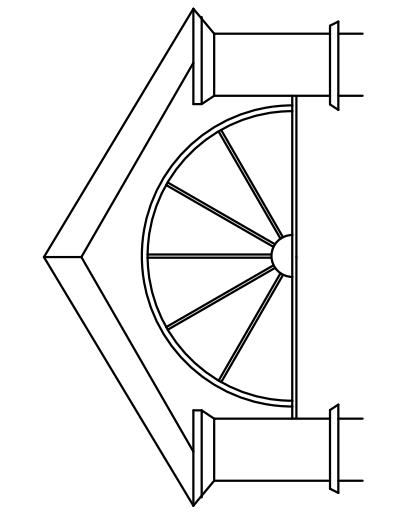

JEFFREY T. BUTLER, P.E., P.C.
 P.O. BOX 634
 SHOREHAM, NEW YORK
 TEL.: 631.208.8950 FAX: 631.727.8033

ENGINEER:
 JEFFREY T. BUTLER, P.E.

CONCEPTUAL SITE PLAN FOR:
 SALTAIRE PUBLIC SAFETY BUILDING
 SALTAIRE, N.Y.

COUNTY OF SUFFOLK VILLAGE OF SALTAIRE
 JOB No.: 170008 DRAWN BY: RAC
 DATE: 04-20-2017 APPROVED BY: JTB



A-9.0

PERSPECTIVES
PROPOSED DESIGN FOR:

\$

%

#

JEFFREY T. BUTLER, P.E., P.C.

\$

%

#

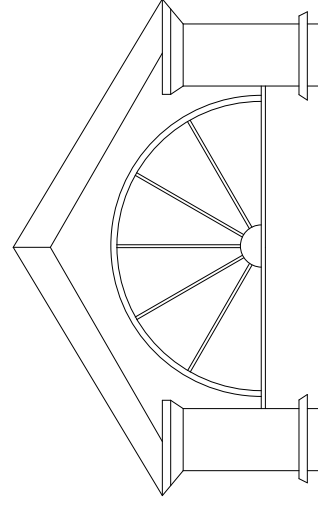

#

%

#